

PLAN

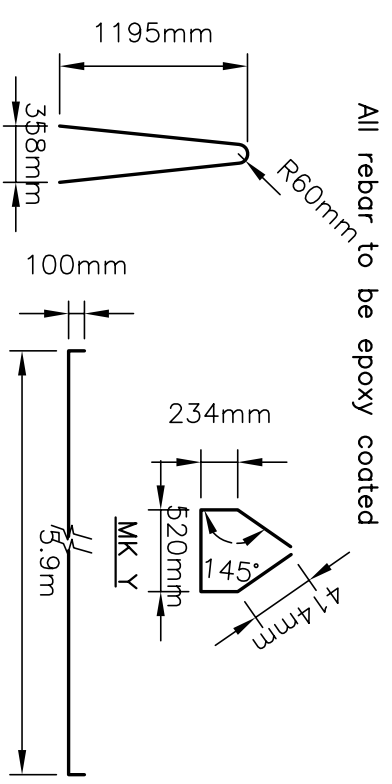

BENDING SCHEDULE

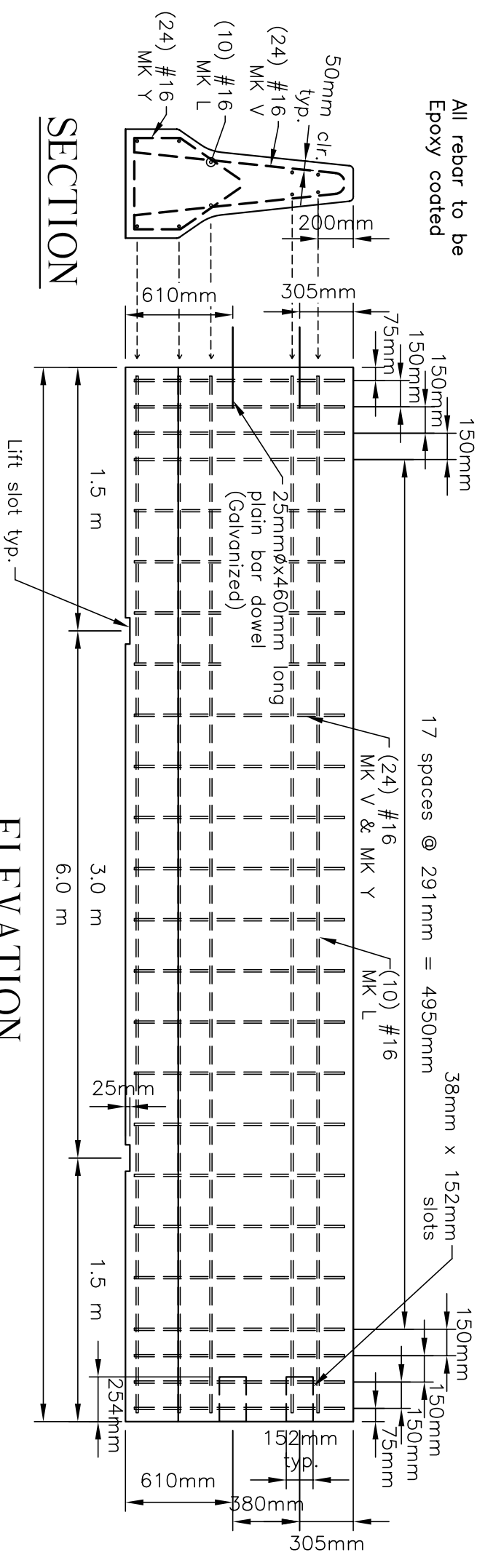

ELEVATION

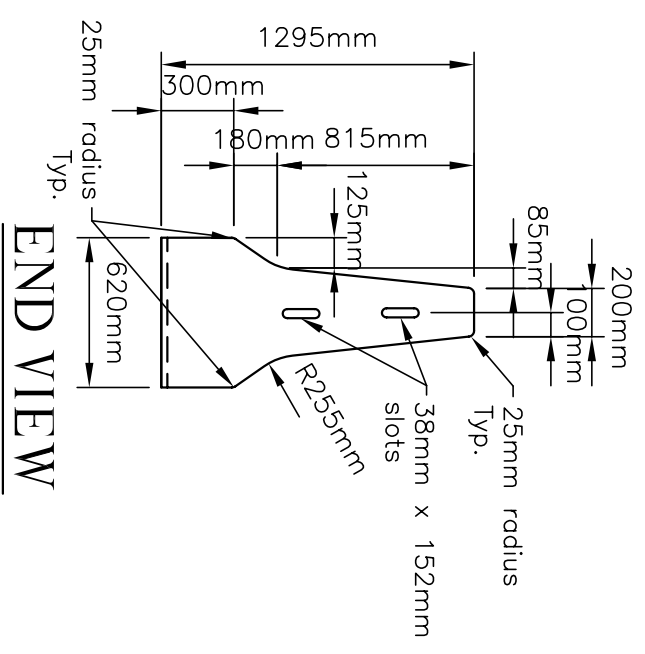

END VIEW

All rebar to be Epoxy coated

All rebar to be epoxy coated



STATE AGENCY
Concrete Systems Inc.
 9 Commercial St., Hudson, NH, 03051
 Phone 603-889-4163
 Fax 603-889-0039

MASS PERMANENT

DOUBLE FACE F SHAPE TALL BARRIER

Drawn By	Date	No. Required	Drawing No.	REV
CONCRETE CO. YD.	WEIGHT	B	DF6201295PMA-1	0
3.98	8.06 TONS	SCALE :	SHEET 1 OF 1	
Approved By	Date			