

PLAN

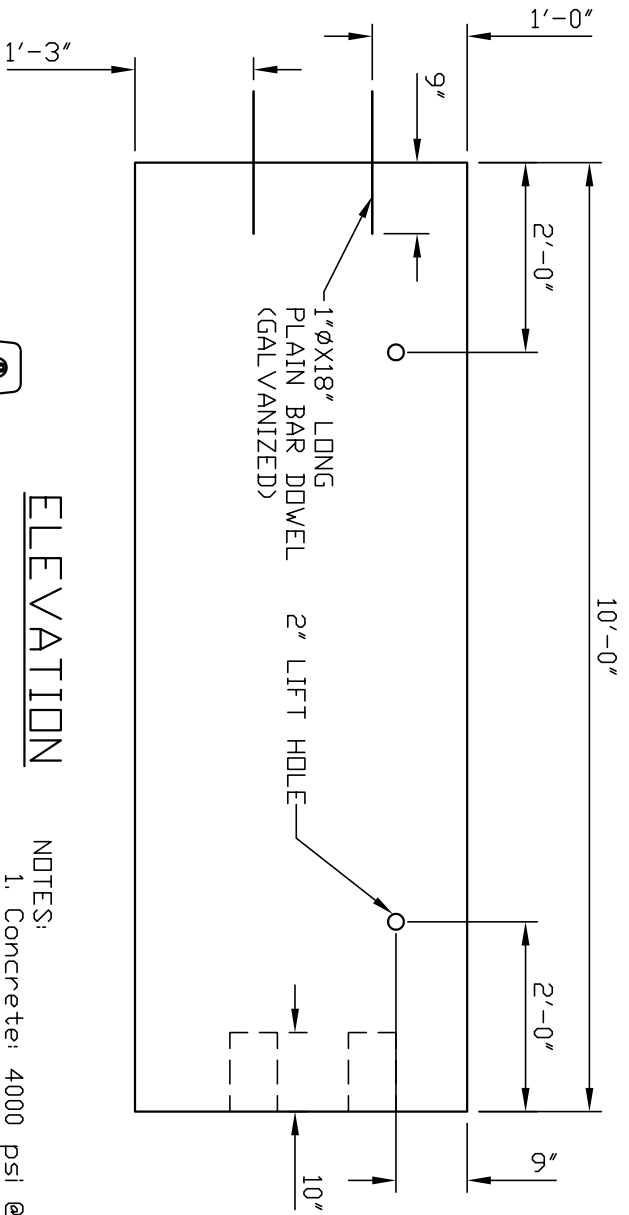

ELEVATION

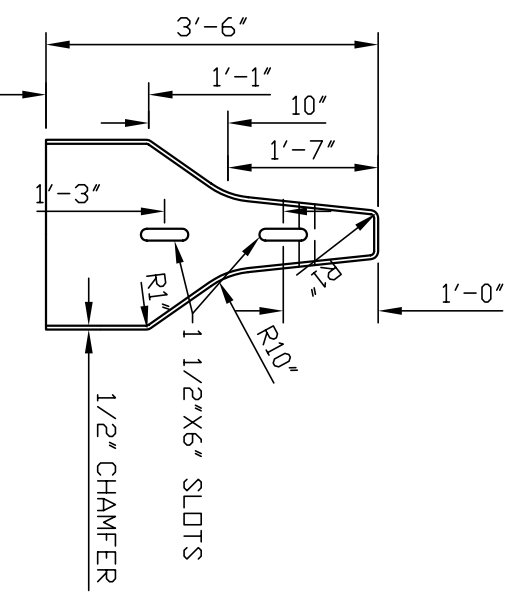

END VIEW

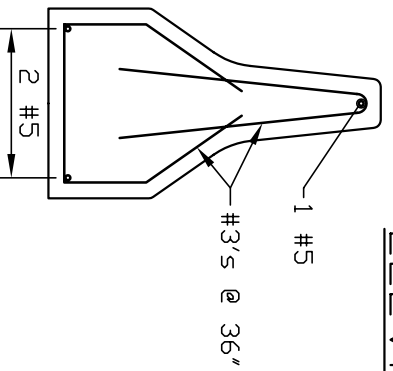

SECTION

- NOTES:
1. Concrete: 4000 psi @ 28 days
 2. Reinforcing: Grade 60, Epoxy Coated



Concrete Systems Inc.
9 Commercial St., Hudson, NH 03051
Phone 603-889-4163
Fax 603-889-0039

Drawn By _____ Date _____

CONCRETE CU. YD. _____ WEIGHT _____

1.63 3.31 tons
Approved By _____ Date _____

PERM. DOUBLE FACE BARRIER

No. Required

Drawing No.

A

DFJ244210P

SCALE : 1/2" = 1'-0"

SHEET 1 of 1